



Notes for GTH FloorsPlus SPC floor installation:

- ✓ Handle with care in the process of transportation and handling to avoid damage to the locking of flooring. Please put it on the flat ground, no erect or sideways.
- ✓ Installing flooring on flat and clean ground. The height difference tolerance is no more than $+ / - 1\text{mm}$. It is recommended to make ground leveling or self-leveling first.
- ✓ Leaving 8mm-10mm expansion joints around when installing the floor.
- ✓ If the area exceeds 300 square meters and the length or width exceeds 15 meters, please using the floor partition and expansion joints shall be added.
- ✓ Advising to use 1mm-1.5mm floor padding or mute mat under the floor. Do not use floor mat or other materials.
- ✓ In the process of installation, install the short side first and then the long side. The lock button can be gently buckled in place. Do not use tools or heavy objects to knock the lock button, to avoid over-tight floor installation and locking damage.
- ✓ After installation, please protect the floor and pay attention to daily maintenance.

Guang Tai He Import and Export INC.

2020.01.01

GTH FloorsPlus SPC flooring Install Preview:

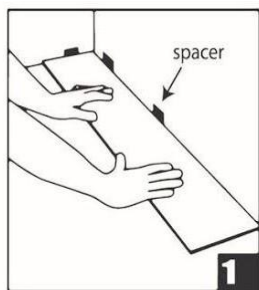

Start at a corner.
Place first plank with tongue side facing wall.
Use spacers to maintain an expansion space of 2-3 mm between wall and flooring.

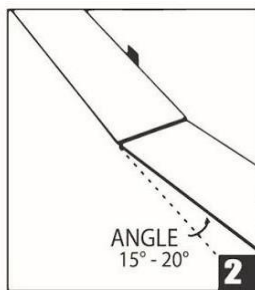

Insert 2nd plank's end tongue to 1st plank's end groove at an angle of 15° to 20°. The plank will click into place when lowered. Line up edges carefully. Planks should be flat to the floor.

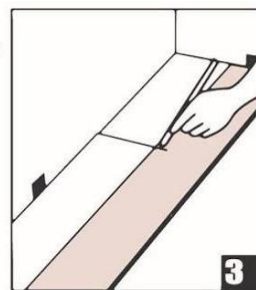

For the last plank of a row, flip a full plank to its under side and place beside the row. Measure and mark the required length. Use a ruler and utility knife to score the plank and snap off. Insert as per previous diagram.

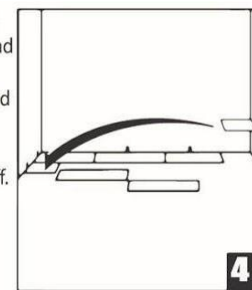

Begin next row with the last cut off piece from the previous row to stagger the pattern.

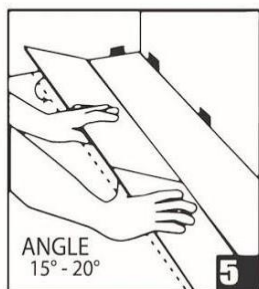

To start second row, assemble your entire row on the subfloor before attaching it to the first row. To attach, tilt and push the side tongue into the side groove of the first row at an angle of 15° to 20°. Lower and click into place lining the edges up carefully. Continue laying remaining planks in this manner.



To fit the final row, lay a plank upside down on the flooring as per diagram with the tongue side close to the wall. Take another plank and place it right on top of the previous row and use it as a ruler. Don't forget to allow room for spacers. Cut the plank and attach into position.

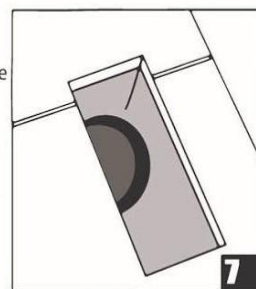

Heating vents require expansion room. First, cut plank to the correct length. Place the cut plank at its actual position and use a ruler to measure the areas to be cut out and mark them. Cut out the marked points allowing the necessary expansion distance.

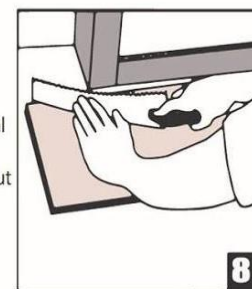

The gap between the bottom of a door and the vinyl flooring should be 1 cm height. To trim door frames, turn a plank upside down. Place it next to the door frame as per diagram. Use a handsaw and cut away the necessary height so that the planks can slide easily underneath the frame.



GTH FloorsPlus SPC flooring daily maintenance:

- ✓ Preventing sharp objects delimit to the floor wear-layer. Avoid leaving ugly and eliminating scratches, affect the overall view of the floor.
- ✓ Avoiding long time of direct sunlight or exposure, preventing the color fading of wear-layer or bulge.
- ✓ Placing articles with temperature over 60 °C on the floor for a long time is prohibited.
- ✓ The floor is waterproof. Daily sweeping, just water to mop the floor.
- ✓ Waxing is no need.

Guang Tai He Import and Export INC.

2020.01.01